

TYPICAL APPLICATION - LINER (NOT POTABLE WATER)

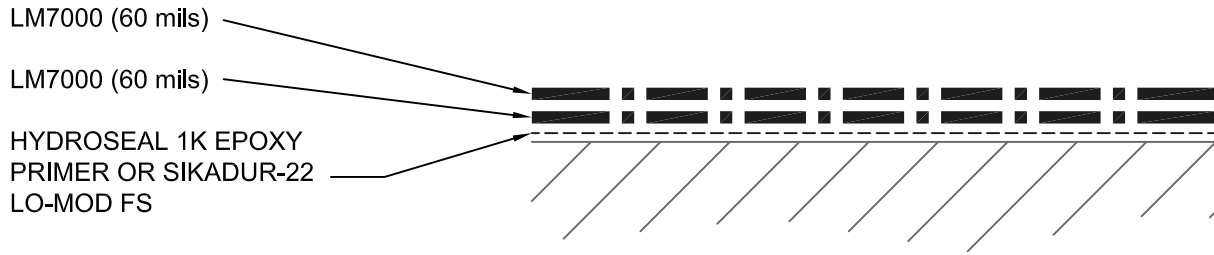

TYPICAL APPLICATION - LINER FOR POTABLE WATER CONTAINMENT/TANK

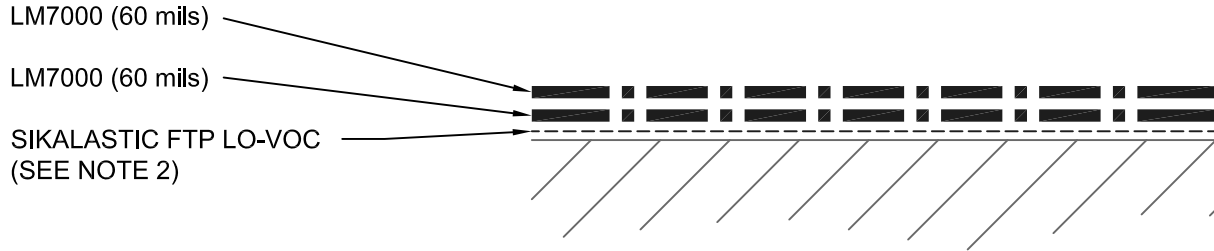

TYPICAL PROTECTED MEMBRANE APPLICATION

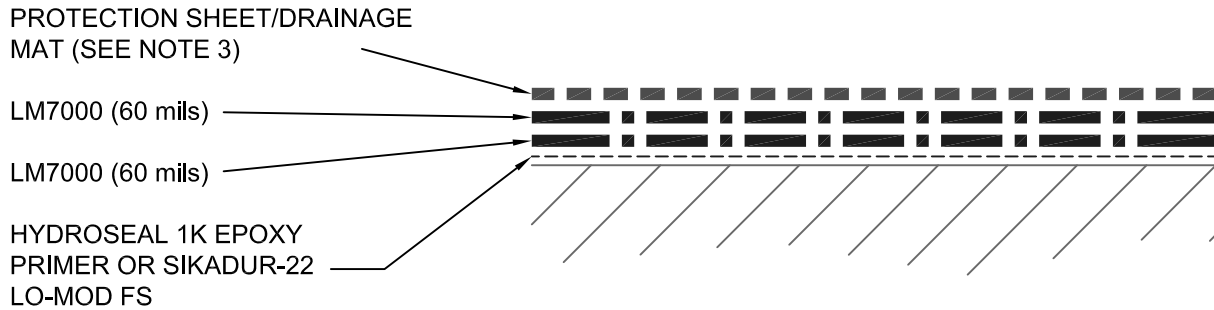

FABRIC REINFORCED APPLICATION

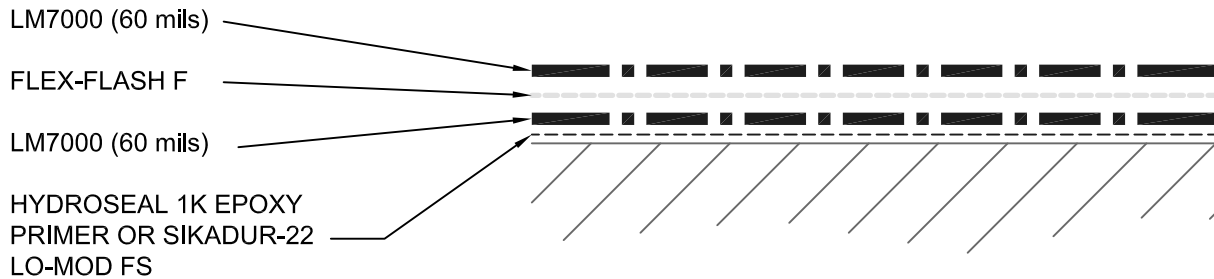

NOTES:

1. REFER TO LM7000 TECHNICAL DATA SHEET FOR FURTHER INFORMATION
2. CONTACT AMERICAN HYDROTECH TECHNICAL SERVICES DEPARTMENT FOR INFORMATION ON POTABLE WATER APPLICATION AND COMPLIANCE WITH NSF61 REQUIREMENTS
3. REFER TO "SYSTEM GUIDELINE OPTIONS" FOR LM7000 FOR SPECIFIC REQUIREMENTS



Liquid Membrane
7000

AMERICAN HYDROTECH, INC.

**LIQUID MEMBRANE 7000
APPLICATION**

SCALE: NONE
DATE: 05/24

LM-1