

LAWN

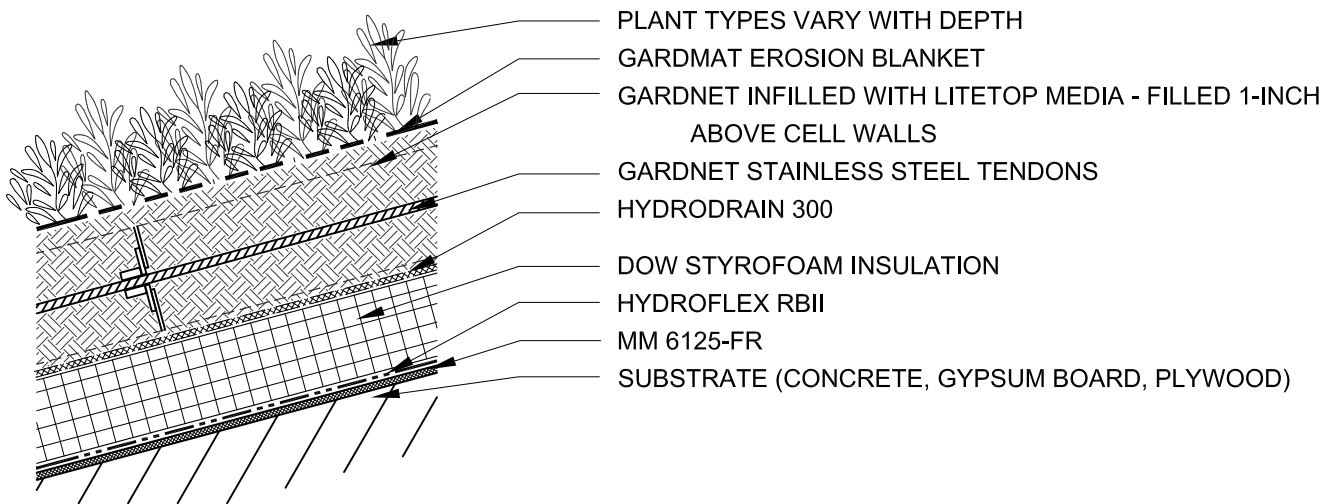

STEEP SLOPE* (3:12 TO 12:12; SEE NOTES BELOW)

NOTES:

1. ADDITIONAL COMBINATIONS OF GARDEN ROOF ASSEMBLY COMPONENTS ARE POSSIBLE TO FIT SPECIFIC PROJECT REQUIREMENTS. CONTACT HYDROTECH FOR VARIATIONS ON ABOVE ASSEMBLIES.
2. INSTAGREEN SEDUM CARPET AND INSTAGREEN SEDUM TILE MAY BE USED IN SLOPED APPLICATIONS IN LIEU OF THE VEGETATION AND GARDMAT EROSION BLANKET.
3. IF INSULATION IS NOT INSTALLED IN THE STEEP SLOPE APPLICATION, HYDRODRAIN 300 MUST BE REPLACED WITH HYDRODRAIN 302 PLACED DIRECTLY ON THE HYDROFLEX RB II.
4. DEPENDING ON SPECIFIC CONDITIONS, GARDNET MAY BE MORE APPROPRIATE AT MODERATE SLOPE AS WELL. CONSULT HYDROTECH.



HYDROTECH

GARDEN ROOF ASSEMBLY

AMERICAN HYDROTECH, INC.

TYPICAL STANDARD GARDEN ROOF ASSEMBLIES EXTENSIVE AND INTENSIVE

SCALE: NONE DATE: 11/01/17	GA-1B
-------------------------------	-------

This information is intended only for general conceptual purposes. It is based on data and knowledge considered to be true and correct. It is offered for the user's consideration, investigation and verification and is not intended to substitute for the advice provided by appropriate professionals. Hydrotech assumes no liability for the use of this information. The determination of the suitability and applicability of this information is the sole responsibility of the user.